

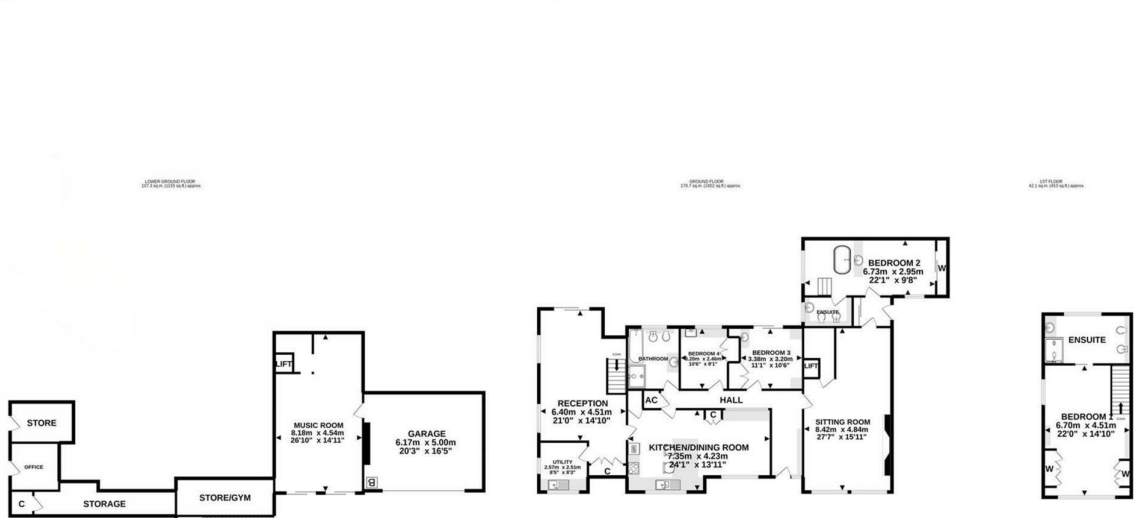

Highfield Maundown, Wiveliscombe, Taunton, Somerset, TA4 2BU



TOTAL FLOOR AREA : 326.1 sq.m. (3510 sq.ft.) approx.
Made with Metropix ©2022

Viewing strictly through the selling agents:

Robert Cooney

Corporation Street, Taunton,
Somerset TA1 4AW

Telephone: 01823 230 230

E-mail: taunton@robertcooney.co.uk

Website: www.robertcooney.co.uk



**robert
cooney**

For clarification, we wish to inform prospective purchasers that: these particulars are set out as a general outline only for the guidance of intended purchasers, and do not constitute, nor constitute part of, an offer or contract; all descriptions, dimensions, references to condition and necessary permission for use and occupation, and other details, are given without responsibility and any intending purchasers should not rely on them as statements or representation of fact, but must satisfy themselves by inspection or otherwise as to the correctness of each of them; no person in the employment of Robert Cooney has any authority to make or give any representation or warranty whatever in relation to this property; we have not carried out a detailed survey nor tested the services, appliances and specific fittings.